

# Hardware Installation Guide

Thank you for purchasing Cluster Box. This guide is designed to guide you through installation.

## Package list

Check the package and ensure that the following items are included. If any item is missing or damaged, contact your sales representative for help:

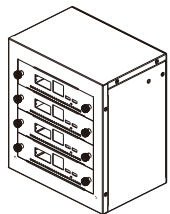

1x Cluster Box

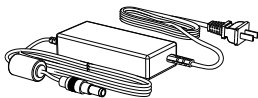

1x Power adapter  
(19 V 4.74 A)



4x M3\*4 Phillips pan head machine screw with washer



8x M3\*5 Phillips round head machine screw



8x M3\*10 Phillips round head machine screw

## Preparations

Besides the packaged items, you also need to prepare the following items for Cluster Box installation:

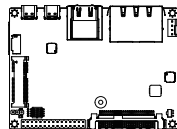

4x Mixtile Blade 3 boards  
(by default)

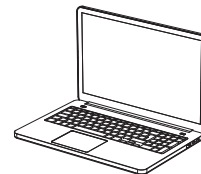

1x PC

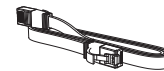

1x Ethernet cable

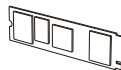

1x M.2 NVMe SSD  
(Optional)



1x Phillips screwdriver

## Installation Steps

### 1 Install Mixtile Blade 3 boards

- Loosen the two captive screws on the motherboard tray with the indication NI by turning them counterclockwise. Then take out the motherboard tray.
- Use a Phillips screwdriver to loosen the four screws (two flat head screws + two M3\*10 round head screws) that secure the heatsink to the motherboard tray. Push the heatsink outwards and remove the heatsink from the motherboard tray.
- Place the Blade 3 on the heatsink. Note that Blade 3's MIPI CSI interface must face the heatsink's notch and their screw holes line up.
- Attach Blade 3 to the heatsink. Install two M3\*10 Phillips round head machine screws to the holes far away from the heatsink's notch.
- Slide the combined unit into the motherboard tray. Reinstall the two flat head screws to secure the heatsink on the motherboard tray, and install two M3\*5 Phillips round head machine screws to the screw holes near the heatsink's notch.
- Place the assembled Blade 3 unit to the corresponding slot on Cluster Box and secure the two captive screws by turning them clockwise.
- Repeat steps (A) to (F) to install the other three Blade 3 boards in Cluster Box.

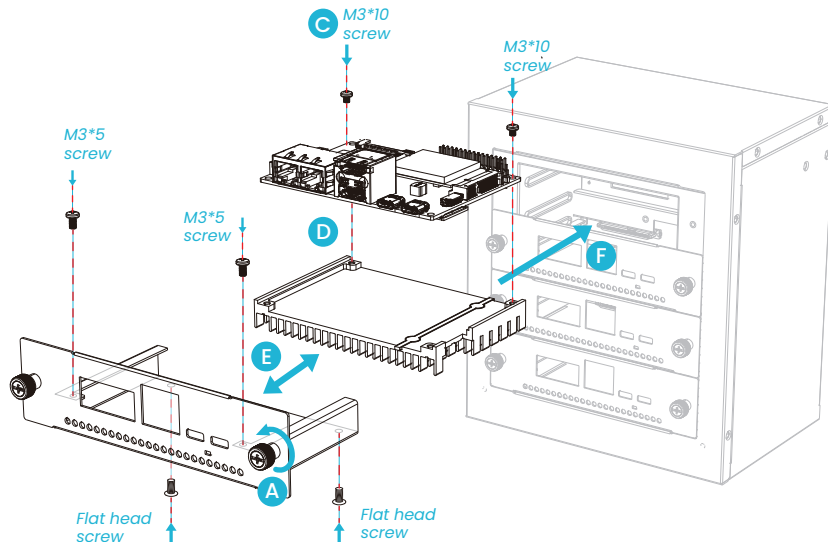

## Installation Steps

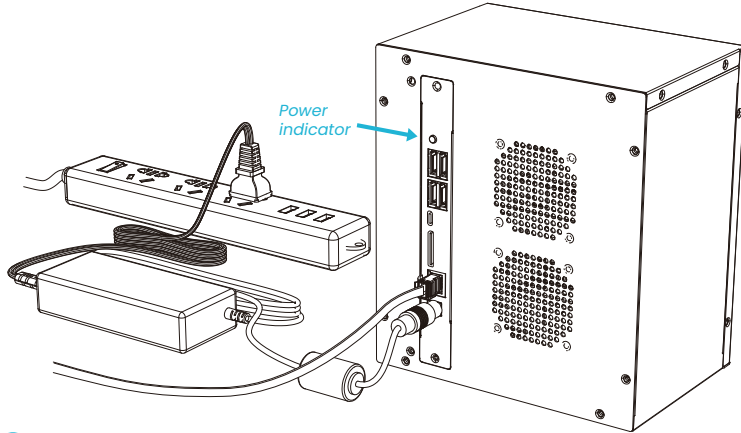

### 2 Connect power

Connect one end of the power adapter to the power port of Cluster Box and the other end to a power source. You'll notice that the LED lights up blue, indicating that Cluster Box is powered on. By default, the Blade 3 boards are powered on sequentially.

### 3 Connect to network

Connect the Ethernet cable to the RJ45 interface of Cluster Box.

## Follow-up Procedure

1. Via GUI:
  - a. Enter the IP address of Cluster Box in your browser.
  - b. On the login page, retain the username **mixtile** and enter password **mixtile**. Then you are directed to the GUI of Cluster Box.
2. Via SSH:
  - a. In the terminal, type `ssh mixtile@Cluster Box IP address`.
  - b. Type password **mixtile** and press **Enter**.

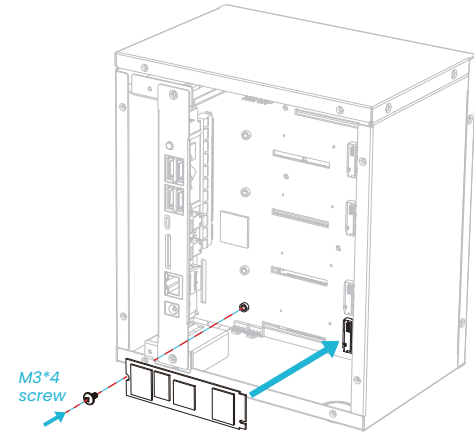

### 4 Install SSDs (Optional)

- A. Open the rear cover of Cluster Box.
- B. Install the SSD into the NVMe M.2 slot using M3\*4 Phillips pan head machine screws with washers.

## Learn More

For more information, visit <https://www.mixtile.com/> or scan the QR code below.

